



Tofflon

Tailored Bioprocess Solutions for Diverse Vaccine Factories in the Developing Countries



202510/29

Content



Introduction

Challenges in Vaccine Production for Developing Countries



Core Principles

Affordability, Adaptability, Accessibility



Case Study

Vietnam Dengue Vaccine Factory



Conclusion

Value & Promotion of Customized Solutions

PART 01 ▶

Challenges in Vaccine Production for Developing Countries

Introduction: The Critical Need

- Addressing global health inequality through localized solutions
- ✓ Developing countries face significant barriers to equitable vaccine access and local production.
- ✓ Global health inequality highlighted by pandemics (e.g., COVID-19) and endemic diseases (e.g., Dengue).
- ✓ Africa CDC 2040 Vision: Target of 60% local vaccine production to enhance health security(AVMA).
- ✓ This presentation explores customized bioprocess solutions as a key enabler.

Vaccine Coverage by Region (2022)

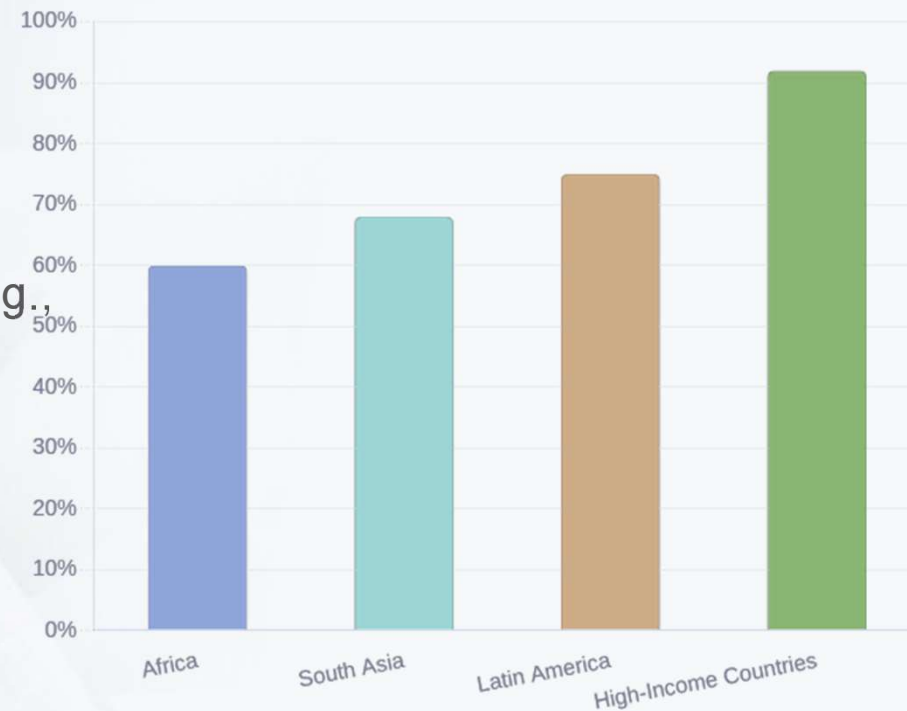

[Sources : Vaccine Accessibility and Global Equity, 2023]

Challenges:

- High production costs due to **small-scale** operations.
- Limited R&D and **substance** manufacturing capabilities.
- Over-reliance on fill and finish (F&F), risking oversupply and commercial unviability.
- Weak public procurement forecasting and financial support
- shortage of specialized **technical talent**

■ The challenging cycle

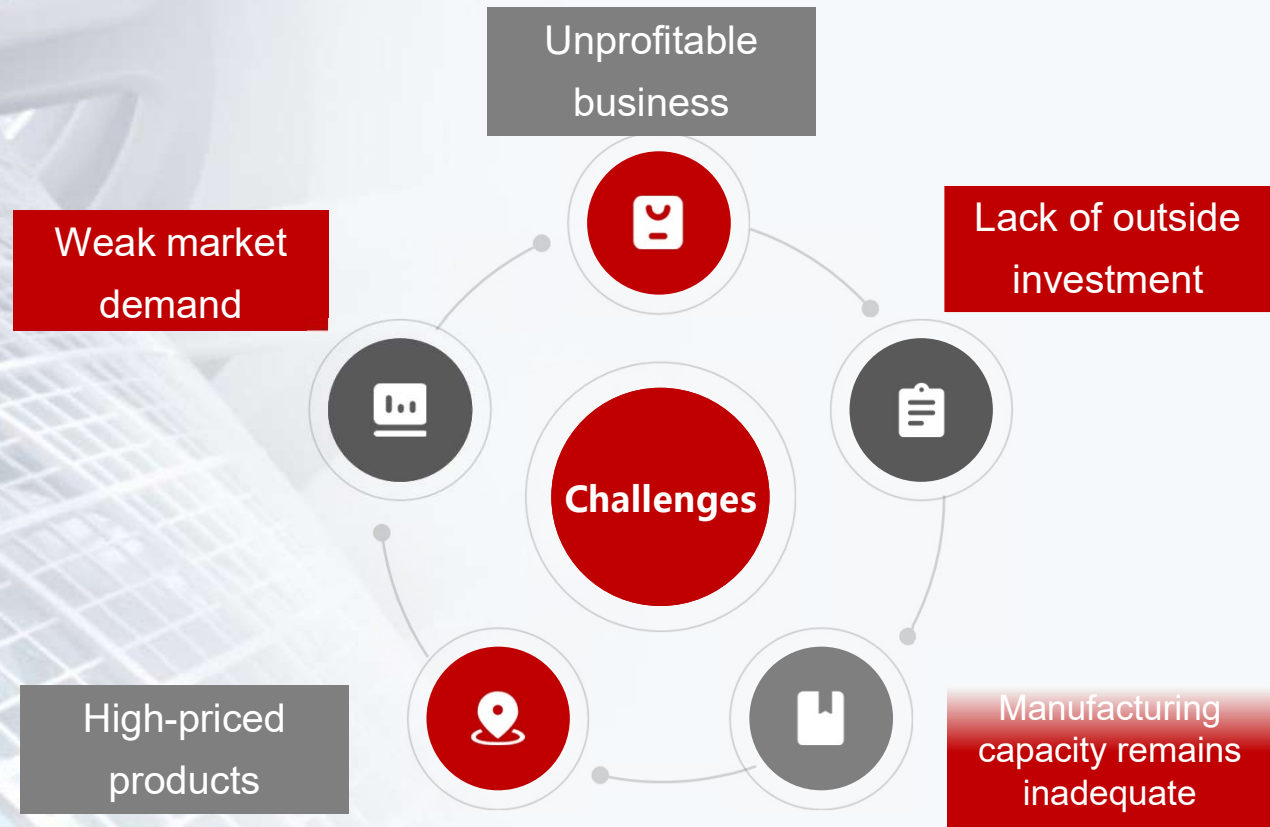

What are the Challenges in NEW VACCINE Facility Project?

Challenges

Bacterial

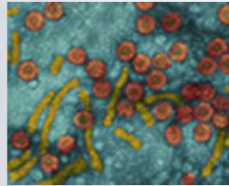

Virus

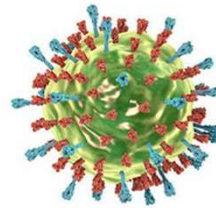

Phase One	Phase Two
BCG(Fermenter ,IA)	PCV
Tetanus(Fermenter ,IA)	ACW135
Measles(Egg Base/Cell Factory,LA)	HPV
Rabies(Vero/Diploid,IA)	DTP-HIB-HEP
Yellow Fever(Egg Base ,LA)	IPV
OCV(RP)	Others

01

- Bioprocess Technology
- Technology Transfer
- MST Capability



02

- Facility Design
- Multi-Production
- Combined vaccine



03

- Product lines tactic

- DP
- DS



PART 02 ▶

Core Principles



Core Principles: Customized Bioprocess Solutions

Customized bioprocessing addresses these challenges through three fundamental pillars:

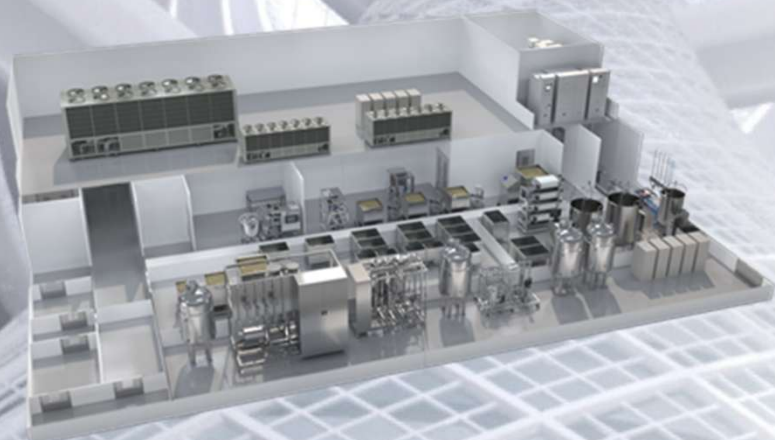

Affordability

Reducing production and infrastructure costs



Adaptability

Enhancing flexibility and operational efficiency



Accessibility

Promoting local production and equitable distribution



Principle 1: Affordability

- ✓ Single-Use Bioreactors (SUBs): XXX Biologics achieved 15-ton mAb production with 5000L SUBs, 3x capacity increase at cost parity.
- ✓ Low-Cost Platforms: BioMilk goat mammary bioreactor reduces mAb cost to < \$35-40/g (60% reduction vs. traditional).
- ✓ Reduced capital expenditure: SUBs require 20-50% lower initial investment than stainless steel systems.

Monoclonal Antibody Production Cost Trend (\$/g)

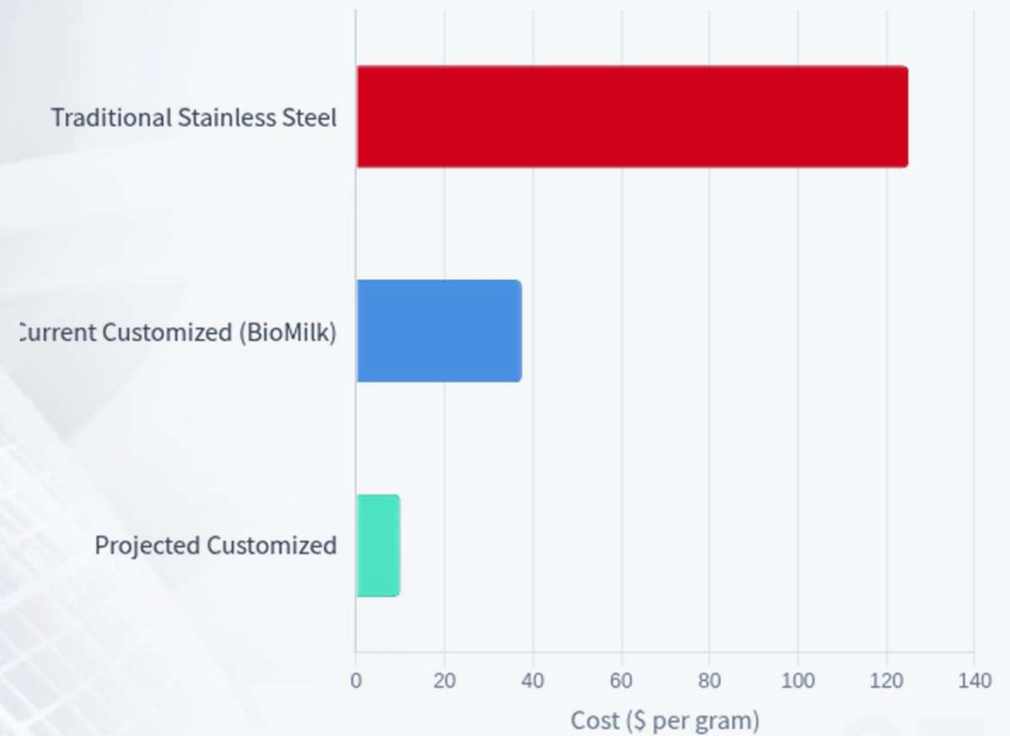

[Source : Gene-Edited Goat Mammary Bioreactor Technology, 2025]



Principle 2: Adaptability & Flexibility

Designing for rapid response and diverse production needs

⚡ **Rapid Product Switching:** SUBs eliminate CIP/sterilization downtime, enabling 48-hour product changeover.

🏗️ **Modular Facilities:** XXP™ process reduces deployment timelines by 40%, adaptable to small-batch and multi-product needs.

📈 **Customized Analytics:** Enzyme conversion and GMP-grade reagents optimize yields by 30% while reducing waste.

80%

Off-site: 80%

10

Turn-key: 10
Month*

5%

Cost predictability:
5%

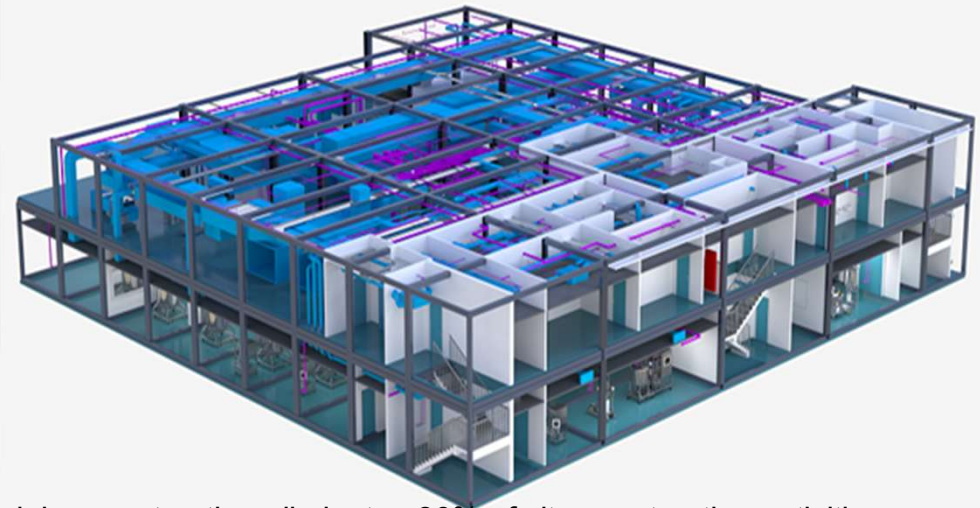

- Modular construction eliminates 80% of site construction activities
- It includes all structural parts, building fixtures, clean room, HVAC, process equipment, utilities, power supply system, auto-control system etc.
- By Modular approach, we can deliver your project like an equipment.

Optimization

- ✓ **Localized Production:** Chinese vaccine companies in Egypt/Colombia, South-South reduced import dependency by **60%**.
- ✓ **End-to-End Support:** China's 'vaccine + cold chain' packages for Iraq increased coverage by **45%**.
- ✓ **Regional Hubs:** XXX factory to serve **100M doses/year** domestic and export markets.

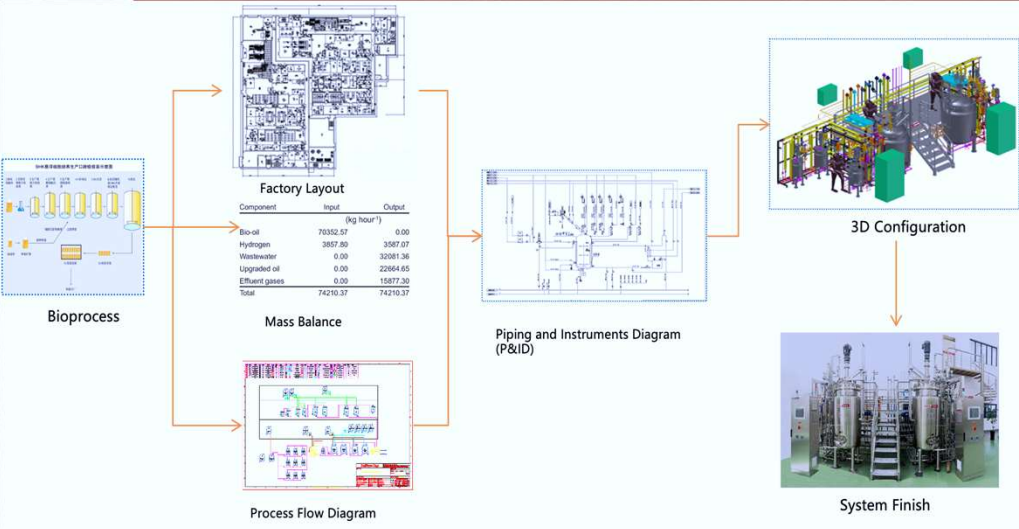

PART 03 ▶

Case Studies

■ Tech Transfer Strategies

■ Facility

Phase 2



Phase 1

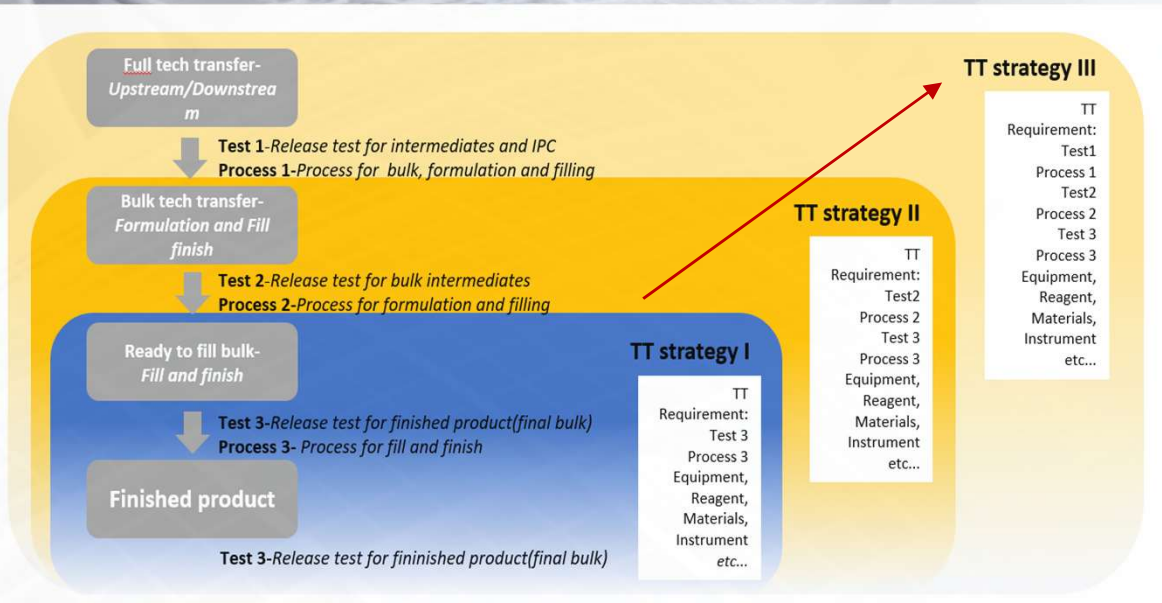

□ DS New Facility

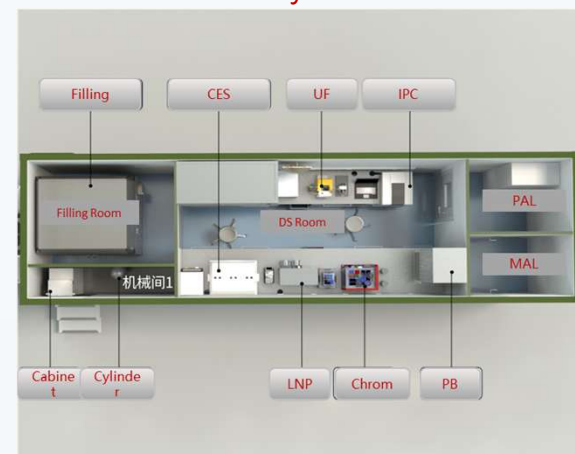

■ DP New Facility

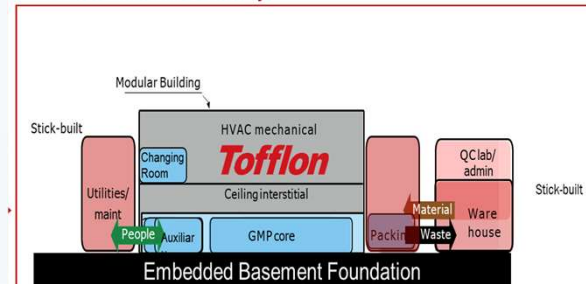

□ Product Pipelines:

- New Tech Vaccines
mRNA/Adv/Recombined Protein /
- Traindion Vaccines

Case Study: Hybrid System-EPC SCOPE

XXX Biopharma Co., Ltd.

Established on July 14, 2020

Produce **Recombinant Protein Vaccine**

Annual capacity of **100 million** doses of vaccine

Project scope

Tofflon **EPMV** project. FAST TRACK

DS+DP+DC+DE of a 12000m2 factory

CES, SSB, SUM, BIN, SS. Bio-process system, HF, DF, TFF, Chrom.,
filling machine, inspection machine, packing machine

Project delivered in 10 months for meeting the urgent requirement

Tofflon

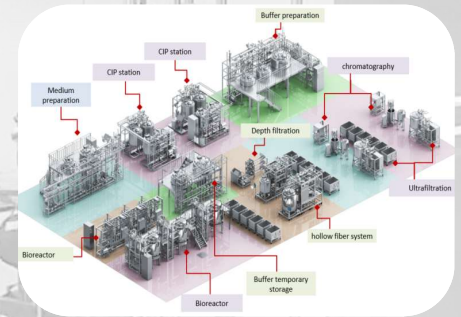

Cost Comparison Analysis

 This comparative analysis highlights the key differences in cost, flexibility, and operational efficiency between traditional stainless steel bioprocesses and modern customized solutions using Single-Use Bioreactors (SUBs) and BioMilk technology.

Dimension	Traditional (Stainless Steel)	Customized (SUBs/BioMilk)
Initial Investment	\$100-400M (12,000L reactor)	\$40-80M (6×2000L SUBs)
Flexibility	<40% utilization, high changeover cost	>85% utilization, 48-hour switch
Operational Cost	High (CIP/sterilization, labor)	50% reduction (water/energy savings)
Yield	30% lower vs. affinity chromatography	30% higher yields, shorter cycles

Initial Investment Comparison (\\$M)

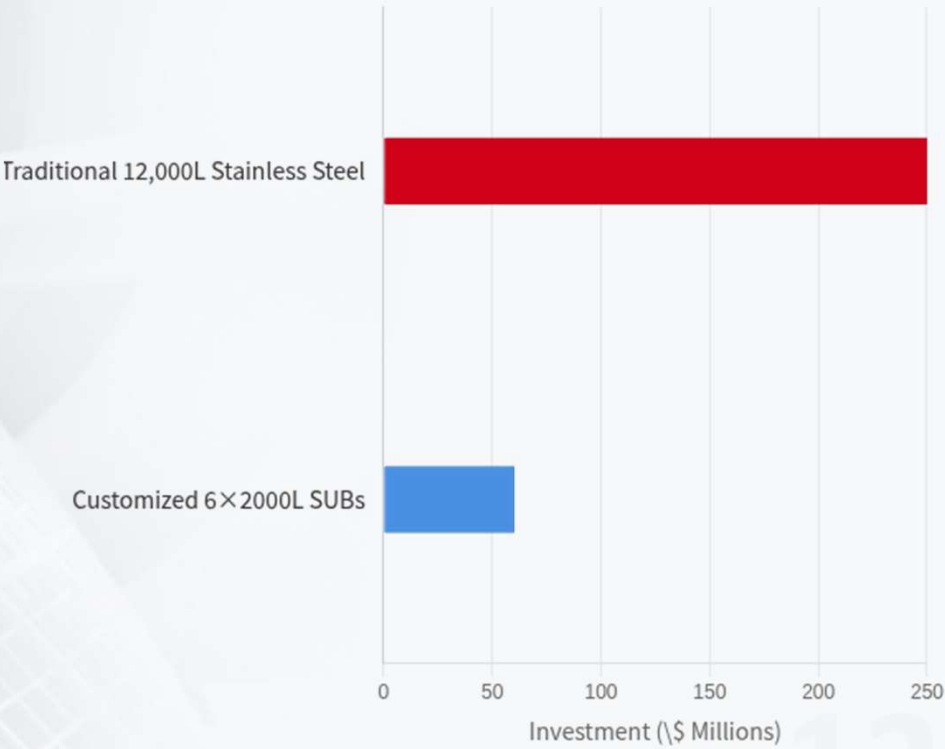

[Source : Bioprocess Equipment Cost Analysis, 2025]

PART 04 ▶

Conclusion

Tofflon

Core Conclusion:

Customized solutions are the key to sustainable localized vaccine production

■ Hybrid DS Facility Layout With Modular

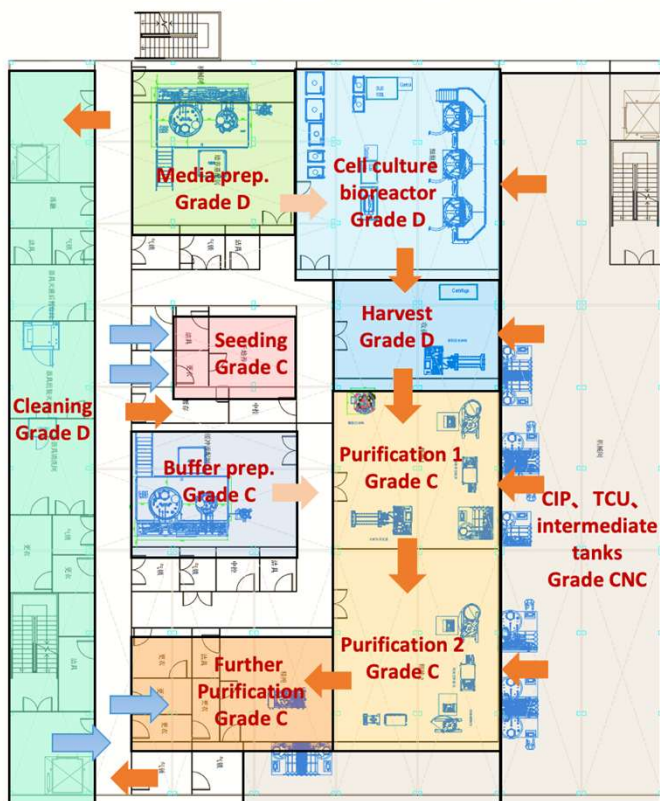

■ Multi-Product collineation

Tofflon

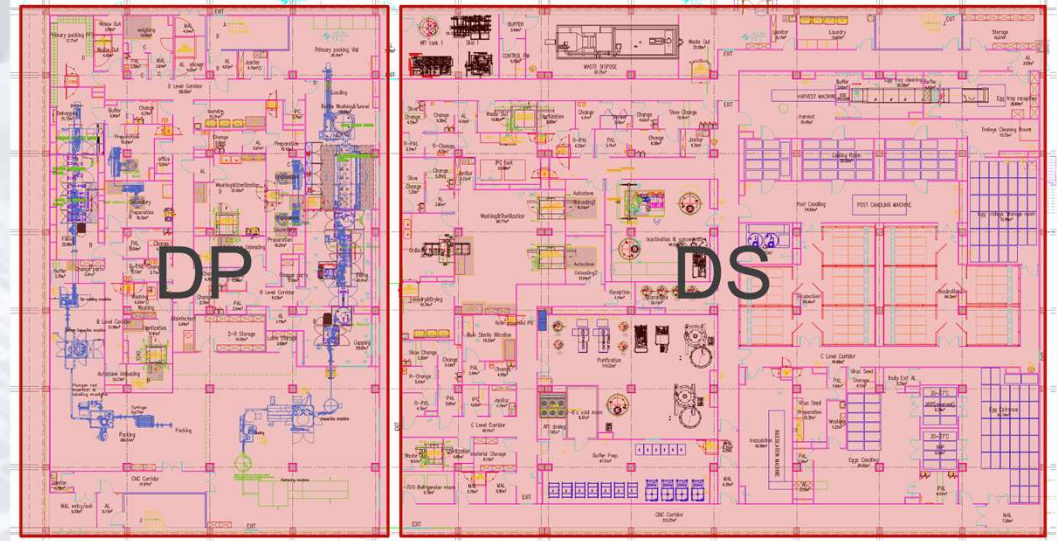

Vial line

Combo Line(Vial+Syringe)

Tofflon

PILOT DESIGN



Engineering Design

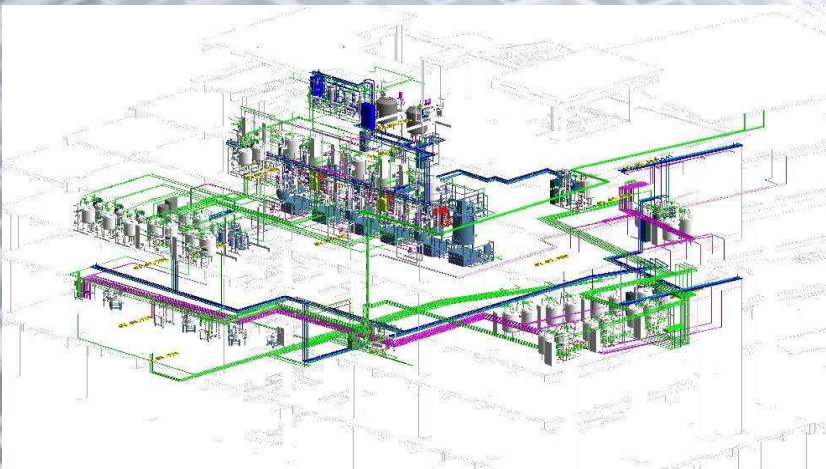

Bio Process Design

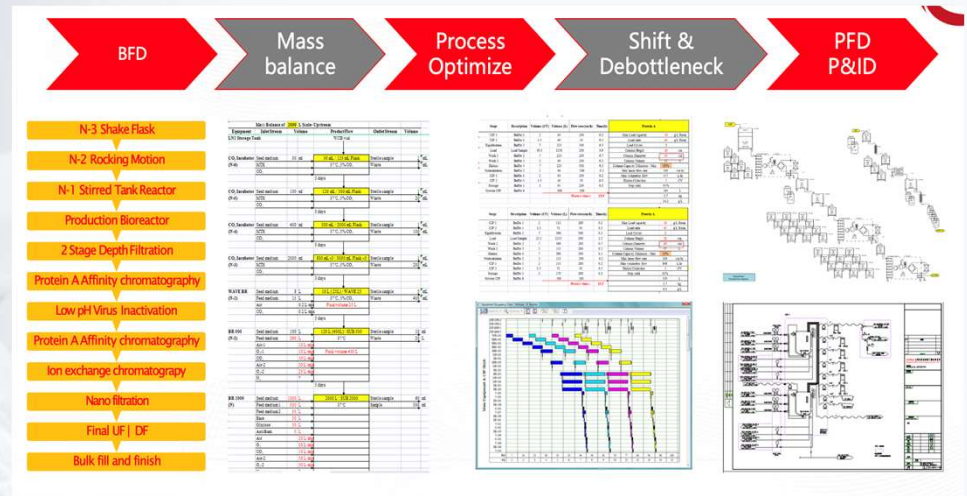

Tofflon

Enterprise Solution For Your Biopharma MFG

Biopharma/CGT

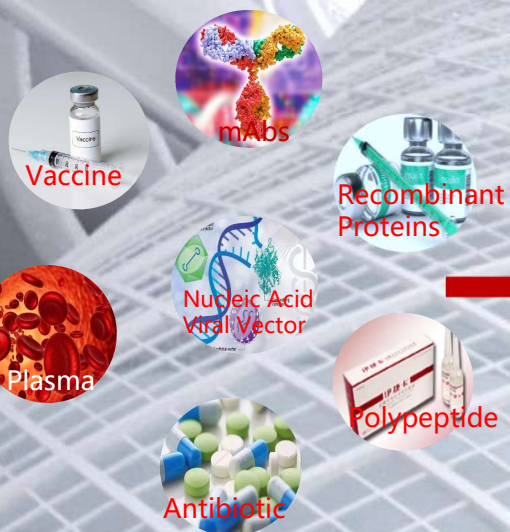

Machine

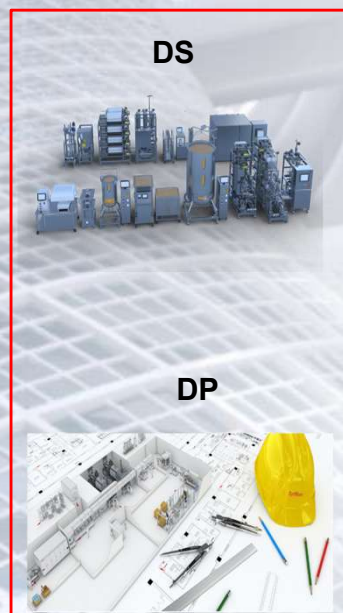

+ **E**ngineering

Modular Facility

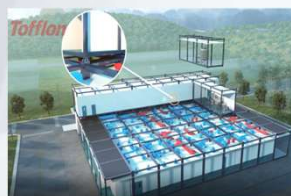

Site Built Construction



+

Services

BD



TT



+

Consumables

DC



R&D/Pilot Scale

Large Scale

Tofflon

**Tofflon Vision:
Smart Pharma Factory Builder**



Thank You